

Appendix 1

Application Form and Notice



Cheshire East
Application to vary a premises licence
Licensing Act 2003

For help contact
licensing@cheshireeast.gov.uk
Telephone: 0300 123 5015

* required information

Section 1 of 17

You can save the form at any time and resume it later. You do not need to be logged in when you resume.

System reference	<input type="text" value="Not Currently In Use"/>	This is the unique reference for this application generated by the system.
Your reference	<input type="text" value="PREM943"/>	You can put what you want here to help you track applications if you make lots of them. It is passed to the authority.

Are you an agent acting on behalf of the applicant?

☒ Yes ☐ No

Put "no" if you are applying on your own behalf or on behalf of a business you own or work for.

Applicant Details

* First name	<input type="text" value="IAN"/>
* Family name	<input type="text" value="COOKE"/>
* E-mail	<input type="text"/>
Main telephone number	<input type="text"/>
Other telephone number	<input type="text"/>

Include country code.

☐ Indicate here if the applicant would prefer not to be contacted by telephone

Is the applicant:

- ☐ Applying as a business or organisation, including as a sole trader
- ☒ Applying as an individual

A sole trader is a business owned by one person without any special legal structure. Applying as an individual means the applicant is applying so the applicant can be employed, or for some other personal reason, such as following a hobby.

Continued from previous page...

Address

* Building number or name	Six Bar & Grill
* Street	6 Crewe Road
District	
* City or town	Alsager
County or administrative area	
* Postcode	ST7 2ES
* Country	United Kingdom

Agent Details

* First name		
* Family name		
* E-mail		
Main telephone number		Include country code.
Other telephone number		
<input type="checkbox"/> Indicate here if you would prefer not to be contacted by telephone		

Are you:

- ☒ An agent that is a business or organisation, including a sole trader
- ☐ A private individual acting as an agent

A sole trader is a business owned by one person without any special legal structure.

Agent Business

Is your business registered in the UK with Companies House?	<input type="radio"/> Yes	<input checked="" type="radio"/> No
Is your business registered outside the UK?	<input type="radio"/> Yes	<input checked="" type="radio"/> No

Note: completing the Applicant Business section is optional in this form.

Business name		If your business is registered, use its registered name.
VAT number	-	Put "none" if you are not registered for VAT.
Legal status	Sole Trader	
Your position in the business	owner	
Home country	United Kingdom	The country where the headquarters of your business is located.

Continued from previous page...

Agent Business Address

If you have one, this should be your official address - that is an address required of you by law for receiving communications.

Building number or name	<input type="text"/>
Street	<input type="text"/>
District	<input type="text"/>
City or town	<input type="text"/>
County or administrative area	<input type="text"/>
Postcode	<input type="text"/>
Country	<input type="text"/>

Section 2 of 17

APPLICATION DETAILS

This application cannot be used to vary the licence so as to extend the period for which the licence has effect or to vary substantially the premises to which it relates. If you wish to make that type of change to the premises licence, you should make a new premises licence application under section 17 of the Licensing Act 2003.

I/we, as named in section 1, being the premises licence holder, apply to vary a premises licence under section 34 of the Licensing Act 2003 for the premises described in section 2 below.

* Premises Licence Number

Are you able to provide a postal address, OS map reference or description of the premises?

☒ Address ☐ OS map reference ☐ Description

Postal Address Of Premises

Building number or name	<input type="text" value="Six Bar & Grill"/>
Street	<input type="text" value="6 Crewe Rd"/>
District	<input type="text"/>
City or town	<input type="text" value="Alsager"/>
County or administrative area	<input type="text"/>
Postcode	<input type="text" value="ST7 2ES"/>
Country	<input type="text" value="United Kingdom"/>

Premises Contact Details

Telephone number	<input type="text"/>
Non-domestic rateable value of premises (£)	<input type="text" value="9,600"/>

Section 3 of 17

VARIATION

Continued from previous page...

Do you want the proposed variation to have effect as soon as possible?

☒ Yes ☐ No

Do you want the proposed variation to have effect in relation to the introduction of the late night levy?

☐ Yes ☒ No

You do not have to pay a fee if the only purpose of the variation for which you are applying is to avoid becoming liable to the late night levy.

If your proposed variation would mean that 5,000 or more people are expected to attend the premises at any one time, state the number expected to attend

Describe Briefly The Nature Of The Proposed Variation

Describe the premises. For example the type of premises, its general situation and layout and any other information which could be relevant to the licensing objectives. Where your application includes off-supplies of alcohol and you intend to provide a place for consumption of these off-supplies, you must include a description of where the place will be and its proximity to the premises.

1. Alter description of premises to a bar & grill and remove condition 7 (Alcohol shall not be sold on the premises otherwise than to persons taking table meals there and for consumption by such persons as an ancillary to their meal).
2. Amend hours of opening/licensable activity times and alter licensable activities to include selling alcohol for consumption on/off premises, performance of live music & playing recorded music & extend licensable area.
3. Change name of premises from Steak House to Six Bar & Grill.

Section 4 of 17

PROVISION OF PLAYS

Will the schedule to provide plays be subject to change if this application to vary is successful?

☐ Yes ☒ No

Section 5 of 17

PROVISION OF FILMS

Will the schedule to provide films be subject to change if this application to vary is successful?

☐ Yes ☒ No

Section 6 of 17

PROVISION OF INDOOR SPORTING EVENTS

Will the schedule to provide indoor sporting events be subject to change if this application to vary is successful?

Continued from previous page...

☐ Yes

☒ No

Section 7 of 17

PROVISION OF BOXING OR WRESTLING ENTERTAINMENTS

Will the schedule to provide boxing or wrestling entertainments be subject to change if this application to vary is successful?

☐ Yes

☒ No

Section 8 of 17

PROVISION OF LIVE MUSIC

Will the schedule to provide live music be subject to change if this application to vary is successful?

☒ Yes

☐ No

Standard Days And Timings

MONDAY

Start

End

Start

End

Provide timings in 24 hour clock (e.g., 16:00) and only give details for the days of the week when you intend the premises to be used for the activity.

TUESDAY

Start

End

Start

End

WEDNESDAY

Start

End

Start

End

THURSDAY

Start

End

Start

End

FRIDAY

Start

End

Start

End

SATURDAY

Start

End

Start

End

SUNDAY

Start

End

Start

End

Continued from previous page...

Will the performance of live music take place indoors or outdoors or both?

☐ Indoors ☐ Outdoors ☒ Both

Where taking place in a building or other structure select as appropriate. Indoors may include a tent.

State type of activity to be authorised, if not already stated, and give relevant further details, for example (but not exclusively) whether or not music will be amplified or unamplified.

small live bands/singers mostly indoor, amplified and occasional outdoor events or under cover (tent).
(Outdoors no later than 2200)

State any seasonal variations for the performance of live music

For example (but not exclusively) where the activity will occur on additional days during the summer months.

Non-standard timings. Where the premises will be used for the performance of live music at different times from those listed, above below.

For example (but not exclusively), where you wish the activity to go on longer on a particular day e.g. Christmas Eve.

Easter Sun, New Years Eve, Valentines Day, Bank Holidays, Xmas Eve, Boxing Day, 1100 - 0100

Section 9 of 17

PROVISION OF RECORDED MUSIC

Will the schedule to provide recorded music be subject to change if this application to vary is successful?

☒ Yes ☐ No

Standard Days And Timings

MONDAY

Start 11:00

End 00:00

Start

End

Provide timings in 24 hour clock (e.g., 16:00) and only give details for the days of the week when you intend the premises to be used for the activity.

TUESDAY

Start 11:00

End 00:00

Start

End

WEDNESDAY

Start 11:00

End 00:00

Start

End

Continued from previous page...

THURSDAY

Start 11:00

End 00:00

Start

End

FRIDAY

Start 11:00

End 00:30

Start

End

SATURDAY

Start 11:00

End 00:30

Start

End

SUNDAY

Start 11:00

End 23:30

Start

End

Will the playing of recorded music take place indoors or outdoors or both?

☐ Indoors

☐ Outdoors

☒ Both

Where taking place in a building or other structure select as appropriate. Indoors may include a tent.

State type of activity to be authorised, if not already stated, and give relevant further details, for example (but not exclusively) whether or not music will be amplified or unamplified.

Indoors recorded music amplified and unamplified and outdoors in beer garden (summer) possibly with tent.
Outdoors no later than 2200

State any seasonal variations for playing recorded music.

For example (but not exclusively) where the activity will occur on additional days during the summer months.

Non-standard timings. Where the premises will be used for the playing of recorded music at different times from those listed above, list below.

For example (but not exclusively), where you wish the activity to go on longer on a particular day e.g. Christmas Eve.

Easter Sun, New Years Eve, Valentines Day, Bank Holidays, Xmas Eve, Boxing Day, 1100 - 0100

Section 10 of 17

PROVISION OF PERFORMANCES OF DANCE

Continued from previous page...

Will the schedule to provide performances of dance be subject to change if this application to vary is successful?

☐ Yes ☒ No

Section 11 of 17

PROVISION OF ANYTHING OF A SIMILAR DESCRIPTION TO LIVE MUSIC, RECORDED MUSIC OR PERFORMANCES OF DANCE

Will the schedule to provide anything similar to live music, recorded music or performances of dance be subject to change if this application to vary is successful?

☐ Yes ☒ No

Section 12 of 17

PROVISION OF LATE NIGHT REFRESHMENT

Will the schedule to provide late night refreshment be subject to change if this application to vary is successful?

☒ Yes ☐ No

Standard Days And Timings

MONDAY

Start

End

Start

End

Provide timings in 24 hour clock (e.g., 16:00) and only give details for the days of the week when you intend the premises to be used for the activity.

TUESDAY

Start

End

Start

End

WEDNESDAY

Start

End

Start

End

THURSDAY

Start

End

Start

End

FRIDAY

Start

End

Start

End

SATURDAY

Start

End

Start

End

Continued from previous page...

SUNDAY

Start

End

Start

End

Will the provision of late night refreshment take place indoors or outdoors or both?

☐ Indoors

☐ Outdoors

☒ Both

Where taking place in a building or other structure select as appropriate. Indoors may include a tent.

State type of activity to be authorised, if not already stated, and give relevant further details, for example (but not exclusively) whether or not music will be amplified or unamplified.

Hot beverages and possibly food inside and beer garden (summer months)

State any seasonal variations.

For example (but not exclusively) where the activity will occur on additional days during the summer months.

Non standard timings. Where the premises will be used for the provision of late night refreshment at different times from those listed above, list below.

For example (but not exclusively), where you wish the activity to go on longer on a particular day e.g. Christmas Eve.

Easter Sun, New Years Eve, Valentines Day, Bank Holidays, Xmas Eve, Boxing Day, 1100 - 0100

Section 13 of 17

SUPPLY OF ALCOHOL

Will the schedule to supply alcohol be subject to change if this application to vary is successful?

☒ Yes

☐ No

Standard Days And Timings

MONDAY

Start

End

Start

End

Provide timings in 24 hour clock (e.g., 16:00) and only give details for the days of the week when you intend the premises to be used for the activity.

Continued from previous page...

TUESDAY

Start 11:00

End 00:00

Start

End

WEDNESDAY

Start 11:00

End 00:00

Start

End

THURSDAY

Start 11:00

End 00:00

Start

End

FRIDAY

Start 11:00

End 00:30

Start

End

SATURDAY

Start 11:00

End 00:30

Start

End

SUNDAY

Start 11:00

End 23:30

Start

End

Will the sale of alcohol be for consumption?

- ☐ On the premises ☐ Off the premises ☒ Both

If the sale of alcohol is for consumption on the premises select on, if the sale of alcohol is for consumption away from the premises select off. If the sale of alcohol is for consumption on the premises and away from the premises select both.

State any seasonal variations.

For example (but not exclusively) where the activity will occur on additional days during the summer months.

Non-standard timings. Where the premises will be used for the supply of alcohol at different times from those listed above, list below.

For example (but not exclusively), where you wish the activity to go on longer on a particular day e.g. Christmas Eve.

Easter Sun, New Years Eve, Valentines Day, Bank Holidays, Xmas Eve, Boxing Day, 1100 - 0100

Continued from previous page...

Section 14 of 17

ADULT ENTERTAINMENT

Highlight any adult entertainment or services, activities, or other entertainment or matters ancillary to the use of the premises that may give rise to concern in respect of children.

Provide information about anything intended to occur at the premises or ancillary to the use of the premises which may give rise to concern in respect of children, regardless of whether you intend children to have access to the premises, for example (but not exclusively) nudity or semi-nudity, films for restricted age groups etc gambling machines etc.

Up to 2 class c/d gaming machines.

Section 15 of 17

HOURS PREMISES ARE OPEN TO THE PUBLIC

Standard Days And Timings

MONDAY

Start 11:00

End 00:30

Start

End

Provide timings in 24 hour clock (e.g., 16:00) and only give details for the days of the week when you intend the premises to be used for the activity.

TUESDAY

Start 11:00

End 00:30

Start

End

WEDNESDAY

Start 11:00

End 00:30

Start

End

THURSDAY

Start 11:00

End 00:30

Start

End

FRIDAY

Start 11:00

End 01:00

Start

End

SATURDAY

Start 11:00

End 01:00

Start

End

Continued from previous page...

SUNDAY

Start 11:00

End 00:00

Start

End

State any seasonal variations.

For example (but not exclusively) where the activity will occur on additional days during the summer months.

Non standard timings. Where you intend to use the premises to be open to the members and guests at different times from those listed above, list below.

For example (but not exclusively), where you wish the activity to go on longer on a particular day e.g. Christmas Eve.

Easter Sun, New Years Eve, Valentines Day, Bank Holidays, Xmas Eve, Boxing Day, 1100 - 0100

Identify those conditions currently imposed on the licence which you believe could be removed as a consequence of the proposed variation you are seeking.

Alcohol shall not be sold on the premises otherwise than to persons taking table meals there and for consumption by such persons as an ancillary to their meal.

☒ I have enclosed the premises licence

☐ I have enclosed the relevant part of the premises licence

Reasons why I have failed to enclose the premises licence or relevant part of premises licence.

Section 16 of 17

LICENSING OBJECTIVES

Describe the steps you intend to take to promote the four licensing objectives:

a) General – all four licensing objectives (b,c,d,e)

List here steps you will take to promote all four licensing objectives together.

There shall be CCTV installed on the premises with at least 4 cameras, fitted to the satisfaction of the police licensing officer. It will continuously record whenever the premises are open to the public. Unedited images will be securely stored for at least 14 days and copies of the images made freely available to the police upon receipt of a reasonable request to do so.

Continued from previous page...

b) The prevention of crime and disorder

CCTV installed.

c) Public safety

There shall be a first aid kit, public safety signage and staff monitoring of patrons at the premises.
Glasses to be collected regularly and any broken glass immediately cleared.
Fire evacuation procedure notices displayed and fire extinguishers inspected annually.

d) The prevention of public nuisance

There shall be a sign displayed at the premises requesting customers to leave quietly.
Ensure doors/windows closed when music live music played after 10pm

e) The protection of children from harm

Children shall not be allowed at the bar.
The proof of age scheme, "Challenge 25" will be operated for all sales of alcohol.

Section 17 of 17

PAYMENT DETAILS

This fee must be paid to the authority. If you complete the application online, you must pay it by debit or credit card.

Variation Fees are determined by the non-domestic rateable value of the premises.

To find out a premises non domestic rateable value go to the Valuation Office Agency site at http://www.voa.gov.uk/business_rates/index.htm

Band A - No RV to £4300 £100.00

Band B - £4301 to £33000 £190.00

Band C - £33001 to £8700 £315.00

Band D - £87001 to £12500 £450.00*

Band E - £125001 and over £635.00*

*If the premises rateable value is in Bands D or E and the premises is primarily used for the consumption of alcohol on the premises then you are required to pay a higher fee

Band D - £87001 to £12500 £900.00

Band E - £125001 and over £1,905.00

If you own a large premise you are subject to additional fees based upon the number in attendance at any one time

Capacity 5000-9999 £1,000.00

Capacity 10000-14999 £2,000.00

Capacity 15000-19999 £4,000.00

Capacity 20000-29999 £8,000.00

Capacity 30000-39000 £16,000.00

Capacity 40000-49999 £24,000.00

Capacity 50000-59999 £32,000.00

Capacity 60000-69999 £40,000.00

Capacity 70000-79999 £48,000.00

Capacity 80000-89999 £56,000.00

Capacity 90000 and over £64,000.00

Continued from previous page...

* Fee amount (£)

DECLARATION

* I/we understand it is an offence, liable on conviction to a fine up to level 5 on the standard scale, under section 158 of the licensing act 2003, to make a false statement in or in connection with this application.

☐ Ticking this box indicates you have read and understood the above declaration

This section should be completed by the applicant, unless you answered "Yes" to the question "Are you an agent acting on behalf of the applicant?"

* Full name

* Capacity

* Date

<input type="text" value="20"/>	/	<input type="text" value="02"/>	/	<input type="text" value="2017"/>
dd		mm		yyyy

Add another signatory

Once you're finished you need to do the following:

1. Save this form to your computer by clicking file/save as...

2. Go back to <https://www.gov.uk/apply-for-a-licence/premises-licence/cheshire-east/change-1> to upload this file and continue with your application.

Don't forget to make sure you have all your supporting documentation to hand.

IT IS AN OFFENCE, LIABLE ON SUMMARY CONVICTION TO A FINE NOT EXCEEDING LEVEL 5 ON THE STANDARD SCALE, UNDER SECTION 158 OF THE LICENSING ACT 2003, TO MAKE A FALSE STATEMENT IN OR IN CONNECTION WITH THIS APPLICATION

OFFICE USE ONLY

Applicant reference number

PREM943

Fee paid

Payment provider reference

ELMS Payment Reference

Payment status

Payment authorisation code

Payment authorisation date

Date and time submitted

Approval deadline

Error message

Is Digitally signed

☐

Agreed Amended Hours from Environmental Health and Cheshire Police

Licensable Activities:

Live Music (Indoors ONLY) 11:30 – 00:00 and Sun 11:30 – 22:30.	Mon – Fri 11:30 – 23:00, Sat
Recorded Music (Indoors ONLY) – 00:00 and Sun 11:30 – 22:30.	Mon – Fri 11:30 – 23:00, Sat 11:30
Late Night Refreshment (Both Indoors & Outdoors) 00:00 and Sun 11:30 – 22:30.	Mon – Fri 11:30 – 23:00, Sat 11:30 –
Supply of alcohol (Consumption ON & OFF) – 00:00 and Sun 11:30 – 22:30.	Mon – Fri 11:30 – 23:00, Sat 11:30

Hours open to the public:

Mon – Fri 11:30 – 23:30, Sat 11:30 – 00:30 and Sun 11:30 – 23:00.

Non-standard timings:

Live Music (Indoors ONLY) Xmas Eve, Boxing Day, 1100 – 0100.	New Year's Eve, Valentine's Day,
Recorded Music (Indoors ONLY) Xmas Eve, Boxing Day, 1100 – 0100.	New Year's Eve, Valentine's Day,
Late Night Refreshment (Both Indoors & Outdoors) Xmas Eve, Boxing Day, 1100 – 0100.	New Year's Eve, Valentine's Day,
Supply of alcohol (Consumption ON & OFF) Xmas Eve, Boxing Day, 1100 – 0100.	New Year's Eve, Valentine's Day,

Conditions -

- There will be no entertainment provided in any external area at the premises.
- No person under 18 years of age may enter or remain on the premises after 22:00 hours.
- The Premises Licence Holder will ensure that a comprehensive risk assessment is conducted, at intervals of not more than 31 days, into the need for door supervisors to be on duty at the premises. This risk assessment will be recorded in writing, produced to a constable or authorised officer of the local authority on request, and a copy retained at the premises for a period of at least 6 months from the date of the assessment.
- When door supervisors are utilised at the premises they will be sourced from a company who is currently accredited under the Security Industry Authority 'Approved Contractor Scheme'.
- A CCTV system shall be installed at the premises to the satisfaction of the Police Licensing Officer and it will record at all times the premises are open to the public. Unedited recordings must be securely stored on site for a period of at least 28 days and copies immediately made available, upon receipt of a lawful request to do so, to a constable or an employee of the Licensing Authority.
- All access and egress for customers after 18:00 hours will take place using the main entrance off Crewe Road and the rear access into the external area will be secured so as to prevent access from 18:00 hours.
- Customers who wish to observe the ban on smoking in public places will be required to use the external area at the rear of the premises and not the footpath on Crewe Road at the front of the building.

As a consequence of variation application itself and the replacement of more onerous conditions than those presently on the premises licence the following existing conditions, from Annex 2, would be deleted/replaced, i.e. 1., 2., 4., 6., 7.

Both existing conditions numbered 3. and 5. will remain unchanged.

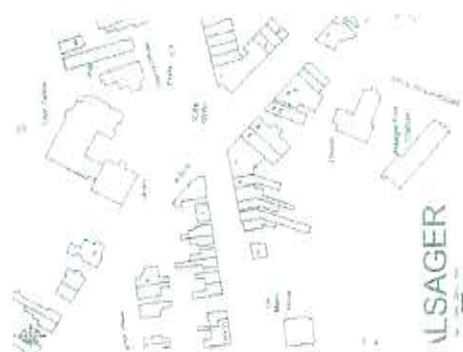

LSAGER

Primap

Location plan 1:250

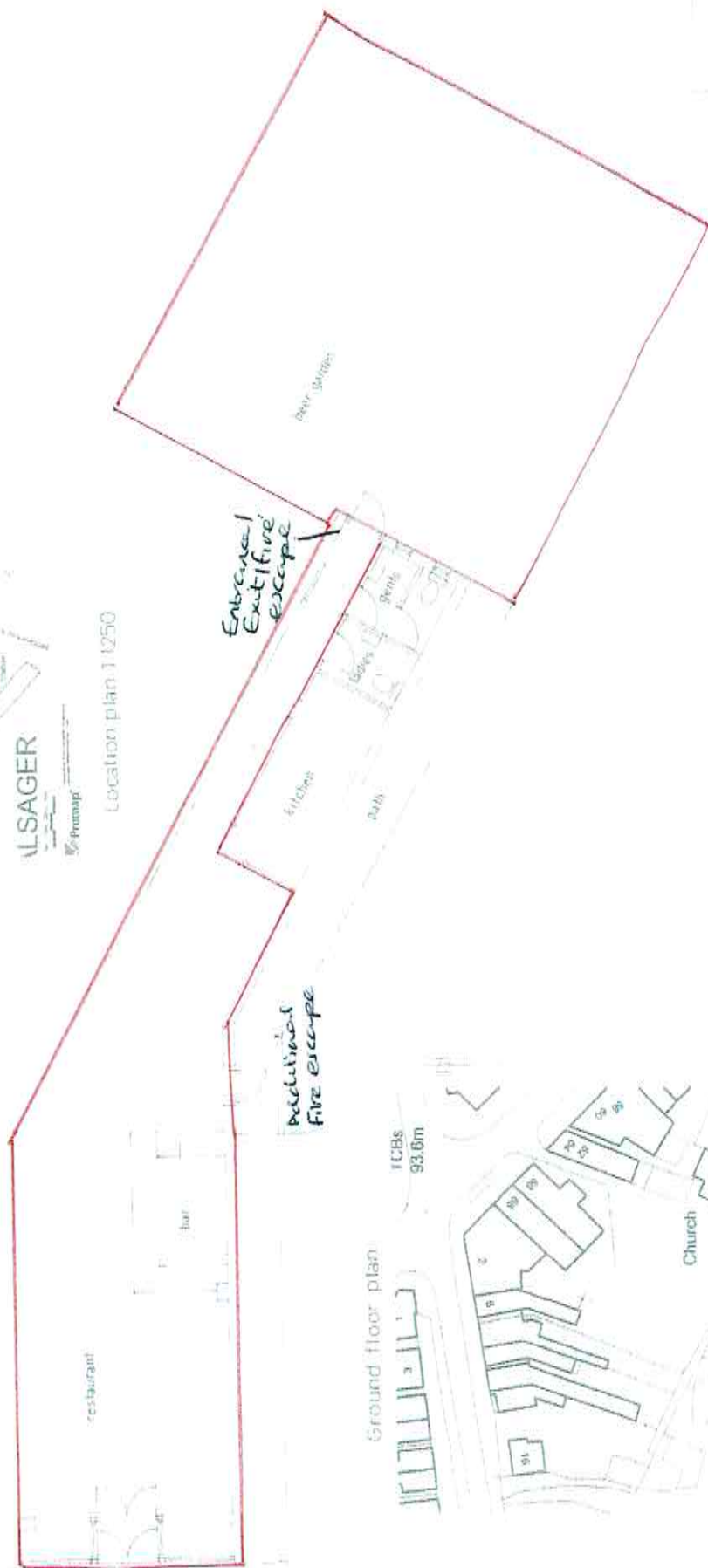

Entrance /
Exit /
Fire
escape

Entrance /
Exit / Fire
escape

Additional
fire escape

Beer Garden

Ground floor plan

ICBs
93.6m



Block plan 1:500



Premises Licence Summary

Premises Licence Number:

PREM943

Premises Details

Postal address of Premises or, if none, ordnance survey map reference or description:

Steak House
6 Crewe Road
Alsager

Post Town: Alsager

Post Code: ST7 2ES

Telephone Number: 01270 878866

Where the Licence is time limited, the dates:

Not applicable

Licensable activities authorised by the Licence:

Sale and supply of alcohol
Late Night Refreshment

The time the Licence authorises the carrying out of licensable activities:

Sale and supply of alcohol
Sunday to Friday 12.30 to 23.30
Saturday 11.30 to 00.30

Late Night Refreshment (to take place indoors only)
Sunday to Friday 23.00 to 23.30
Saturday 23.00 to 00.30

The opening hours of the Premises:

Monday 11.30 to 23.30
Tuesday to Thursday and Sunday 12.00 to 23.30
Friday 12.00 to 00.30
Saturday 11.30 to 00.30

Where the Licence authorises supplies of alcohol, whether these are on and/or off supplies:

Sale of alcohol for consumption on the premises only

Name, (registered) address of holder of Premises Licence:

Mr Ian Cooke

Registered number of holder, for example company number, charity number (where applicable):

Not applicable

Name of designated Premises Supervisor where the Premises Licence authorises for the supply of alcohol:

Ian Cooke

State whether access to the Premises by children is restricted or prohibited:

Children shall not be allowed at the bar.

Licence Issued: 31st January 2017



Signed By: Mr Tony Haskell
On Behalf of Cheshire East Borough Council

Annex 1 - Mandatory Conditions (as applicable)

1. No supply of alcohol may be made under this Premises Licence –
 - a) at a time when there is no designated premises supervisor in respect of the Premises Licence, or
 - b) at a time when the designated premises supervisor does not hold a Personal Licence or his Personal Licence is suspended.
2. Every supply of alcohol under this Premises Licence must be made or authorised by a person who holds a Personal Licence.

Where a Village Hall is exempt from needing DPS under s.19 Licensing Act 2003

Every supply of alcohol under the premises licence must be made or authorised by the Management Committee.

Mandatory condition where the licence authorises the exhibition of films

The admission of children to the exhibition of any film must be restricted in accordance with section 20 of the Licensing Act 2003. Admission of children must be restricted in accordance with any recommendation made by the British Board of Film Classification or the Licensing Authority.

Prohibited conditions: plays

1. In relation to a premises licence which authorises the performance of plays, no condition may be attached to the licence as to the nature of the plays which may be performed, or the manner of performing plays, under the licence.
2. But subsection (1) does not prevent a licensing authority imposing, in accordance with section 18(2)(a) or (3)(b), 35(3)(b) or 52(3), any condition which it considers necessary on the grounds of public safety.

Mandatory condition: Door supervision

Each individual engaged in security activities at the premises must either:

- a) be authorised to carry out that activity by a licence granted under the Private Security Industry Act 2001; or
- b) be entitled to carry out that activity by virtue of Section 4 of the Private Security Industry Act 2001.

LICENSING ACT 2003 (MANDATORY LICENSING CONDITIONS)(AMENDMENT) ORDER 2014

MANDATORY CONDITIONS

Condition 1

1. The responsible person must ensure that staff on relevant premises do not carry out, arrange or participate in any irresponsible promotions in relation to the premises.
2. In this paragraph, an irresponsible promotion means any one or more of the following activities, or substantially similar activities, carried on for the purpose of encouraging the sale or supply of alcohol for consumption on the premises:
 - a) Games or other activities which require or encourage, or are designed to require or encourage individuals to –
 - i. Drink a quantity of alcohol within a time limit (other than to drink alcohol sold or supplied on the premises before the cessation of the period in which the responsible person is authorised to sell or supply alcohol), or
 - ii. Drink as much alcohol as possible (whether within a time limit or otherwise);

b) Provision of unlimited or unspecified quantities of alcohol free or for a fixed or discounted fee to the public or to a group defined by a particular characteristic in a manner which carries a significant risk of undermining a licensing objective;

c) Provision of free or discounted alcohol or any other thing as a prize to encourage or reward the purchase and consumption of alcohol over a period of 24 hours or less in a manner which carries a significant risk of undermining a licensing objective;

d) Selling or supplying alcohol in association with promotional posters or flyers on, or in the vicinity of, the premises which can reasonably be considered to condone, encourage or glamorise anti-social behaviour or to refer to the effects of drunkenness in any favourable manner;

e) Dispensing alcohol directly by one person into the mouth of another (other than where that other person is unable to drink without assistance by reason of disability).

Condition 2

The responsible person must ensure that free potable water is provided on request to customers where it is reasonably available.

Condition 3

1. The premises licence holder or club premises certificate holder must ensure that an age verification policy is adopted in respect of the premises in relation to the sale or supply of alcohol.

2. The designated premises supervisor in relation to the premises licence must ensure that the supply of alcohol at the premises is carried on in accordance with the age verification policy.

3. The policy must require individuals who appear to the responsible person to be under 18 years of age (or such older age as may be specified in the policy) to produce on request, before being served alcohol, identification bearing their photograph, date of birth and either -

a) A holographic mark, or

b) An ultraviolet feature

Condition 4

The responsible person must ensure that –

a) Where any of the following alcoholic drinks is sold or supplied for consumption on the premises (other than alcoholic drinks sold or supplied having been made up in advance ready for sale or supply in a securely closed container) it is available to customers in the following measures -

i. Beer or cider: ½ pint;

ii. Gin, rum, vodka or whisky: 25ml or 35ml; and

iii. Still wine in a glass: 125ml;

b) These measures are displayed in a menu, price list or other printed material which is available to customers on the premises; and

c) Where a customer does not in relation to a sale of alcohol specify the quantity of alcohol to be sold, the customer is made aware that these measures are available.

The Licensing Act 2003 (Mandatory Licensing Conditions) Order 2014

1. A relevant person shall ensure that no alcohol is sold or supplied for consumption on or off the premises for a price which is less than the permitted price.
2. For the purposes of the condition set out in paragraph 1—

- a) 'duty' is to be construed in accordance with the Alcoholic Liquor Duties Act 1979;
- b) 'permitted price' is the price found by applying the formula—

$$P = D + (D \times V)$$

Where —

- i. P is the permitted price,
- ii. D is the amount of duty chargeable in relation to the alcohol as if the duty were charged on the date of the sale or supply of the alcohol, and
- iii. V is the rate of value added tax chargeable in relation to the alcohol as if the value added tax were charged on the date of the sale or supply of the alcohol;

c) 'relevant person' means, in relation to premises in respect of which there is in force a premises licence—

- i. the holder of the premises licence,
- ii. the designated premises supervisor (if any) in respect of such a licence, or
- iii. the personal licence holder who makes or authorises a supply of alcohol under such a licence;

d) 'relevant person' means, in relation to premises in respect of which there is in force a club premises certificate, any member or officer of the club present on the premises in a capacity which enables the member or officer to prevent the supply in question; and

e) 'valued added tax' means value added tax charged in accordance with the Value Added Tax Act 1994.

3. Where the permitted price given by Paragraph (b) of paragraph 2 would (apart from this paragraph) not be a whole number of pennies, the price given by that sub-paragraph shall be taken to be the price actually given by that sub-paragraph rounded up to the nearest penny.

4. (1) Sub-paragraph (2) applies where the permitted price given by Paragraph (b) of paragraph 2 on a day ("the first day") would be different from the permitted price on the next day ("the second day") as a result of a change to the rate of duty or value added tax.

(2) The permitted price which would apply on the first day applies to sales or supplies of alcohol which take place before the expiry of the period of 14 days beginning on the second day.

Annex 2 - Conditions consistent with the Operating Schedule

General – All Licensing Objectives

1. There shall be CCTV installed on the premises.
2. There shall be a first aid kit, public safety signage and staff monitoring of patrons at the premises.
3. There shall be a sign displayed at the premises requesting customers to leave quietly.
4. Children shall not be allowed at the bar.
5. The proof of age scheme 'Challenge 25' will be operated for all sales of alcohol.
6. A CCTV system with at least 4 cameras, fitted to the satisfaction of the police licensing officer, will continuously record whenever the premises are open to the public. Unedited images will be securely stored for at least 14 days and copies of the images made freely available to the police upon receipt of a reasonable request to do so.
7. Alcohol shall not be sold on the premises otherwise than to persons taking table meals there and for consumption by such persons as an ancillary to their meal.

Annex 3 - Conditions attached after a hearing by the Licensing Authority

Not applicable.

Annex 4 - Plans

See attached.

RODE HALL SNOWDROP WALKS
 NOW to Sun 5th March 11 - 4 p.m.
 (Closed Mondays)

Beautiful Spring walk for the whole family with over 70 varieties of snowdrops

Delicious tea room serving homemade light lunches and pastries

Free animal sculpture trail to discover the welcome by appointment

FARMERS' MARKET: 4th March 9 - 1.30 p.m.
ART EXHIBITION: NOW to 5th March

www.rodeshall.co.uk
 Scholar Green, Cheshire, ST7 1QJ
 0170 873232 enquiries@rodeshall.co.uk

Village Events
 you
 as
AMOND
 4 MARCH 2017
 Stage Hall
 7 p.m.
 per person



GA
NNA (HATHA)
 Beginner's Class
 Beginner's improvers
 NEW Beginner's Course
 Starts 03/03 - Booking Essential
 Beginner's improvers
 10 anytime classes £50,
 provided at
 the Farm, Astbury
 0153 595533
 mail.donassimpson53@gmail.com

Key Green Church
 Timbersbrook, CW12 3PY
Jumble Sale
 Saturday, 25th February
 2.30 p.m.
 Refreshments Admission 30p
 People New, Rare & Brics, Books, Toys,
 Jumble Stuff and much more!

The Railway Inn
 Biddulph Road, Congleton
CASH PRIZE BINGO
 Friday 24th February
 8.00 p.m. Start
 Children Welcome

01260 273 737

Pinked Floyd
 4th March, 2017

Tickets available from the Tourist Information Centre 01260 271095 or online via www.danestide.co.uk
 Tickets £12 (000 concession) On the night £15 (£10 concession)

Trinity Amateur Operatic Society
Rock of Ages
 13th-18th March, 2017, 7.30 p.m.

Tickets available from the Tourist Information Centre 01260 271095 or Online via www.bickets.co.uk
 Monday, Tuesday £9
 Wednesday, Thursday £10
 Friday, Saturday £12

Centre Stage
Phantom of the Opera
 28th March - 1st April, 2017, 7.30 p.m.

Tickets £10

Available from the Tourist Information Centre 01260 271095 or email centrestage@kef.co.uk or online www.centrestage.co.uk

Film at Daneside
LaLa Land (12A)
 9th April, 2017, 7.00 p.m.

Tickets available from the Tourist Information Centre 01260 271095
 Price: £5.00 each

White Lion Quiz
 Thursdays - 8.30 p.m. start
£1 entry
 Free food and play your cards right
 cash prizes
 Follow us on Facebook
 Telephone 01260 272702

CLOSURE
OF CONGLETON EDGE
METHODIST CHAPEL
GRAVEYARD

The burial ground at Congleton Edge Methodist Church is to be closed to all new burial. Existing graves and plots that have been purchased will remain available for burial. The Local Government will be notified and in the event of War Graves so will the Ministry of Justice. Access to visit and maintain existing graves will be unaffected. The closure will come into effect of 13th April, 2017.

APPLICATION FOR A MAJOR VARIATION TO A PREMISES LICENCE
LICENSING ACT 2003

NOTICE is hereby given that I, Ian Cooke, have applied on 20th February, 2017 to Cheshire East Council in respect of the premises formerly known as The Steakhouse, now Six Bar & Grill, 6 Centre Road, Alsop, ST7 2BN for a major variation to premises licence to remove conditions 7, extend the licensable area, amend opening times and provide the following licensable activities:

Supply alcohol, Late night refreshment, Recreational music, Live music

Sunday 11.00 - 23.30
 Monday - Thursday 11.00 - 00.00
 Friday - Saturday 11.00 - 00.30
 Opening Hours:
 Sunday 11.00 - 00.00
 Monday - Thursday 11.00 - 00.30
 Friday - Saturday 11.00 - 01.00

Any person wishing to make representation in relation to this application may do so in writing by 20th March, 2017 to: The Licensing Section, Municipal Buildings, Earle Street, Crewe, CW1 2BU

The application may be inspected at the Licensing Section of Cheshire East Borough Council at the address above by prior appointment during normal office hours.

It is an offence to knowingly or recklessly make a false statement in connection with this application, the maximum fine for which is, unlimited.

FRANCIS EMILY LOWE Deceased

Pursuant to the Trustee Act 1925 any persons having a claim or an interest in the Estate of the above-named deceased, late of The Shop, Congleton Road, Alsop, Sandbach, Cheshire, CH11 7UL, who died on 29/01/2017, are requested to send particulars thereof in writing to the undersigned on or before 24/04/2017, having regard only to claims and interests of which they have had notice.

HT Legal Limited Solicitors
 15 Raymond Street, Hyde, Cheshire SK14 1YU

Paul praised for running allergy support group

A support group aimed at individuals or families with severe allergies holds its next meeting on Saturday, 25th March.

Congleton dad Paul Moses formed the Allergy Cheshire support group because his four-year-old son James, a pupil at Quinta Primary, suffers from severe anaphylaxis.

Now Mr Moses, (54), of West Heath, has the help of the Anaphylaxis Campaign, the only UK-wide charity to support people with life-threatening allergies.

Mr Moses said: "I got involved with the campaign after my son James' first anaphylactic reaction at seven months, which was severe. Doctors in A&E failed to diagnose allergy, so it was left to me to search the internet for his symptoms and understand what had happened."

"I was able to get a referral to an allergy specialist where he was diagnosed with wheat and peanut allergies."

Food allergies are thought to affect around 8% of children and 4% of adults. Hospitals in England dealt with more than 20,000 admissions for allergies in the 12 months between February 2013 and February 2014.

Mr Moses continued: "We know of others in our area similarly affected so I have decided to set up a local group, with the support of specialists at our local allergy centre."

"Hopefully the group will help to raise awareness of those at risk of severe allergy, and offer a support network to people in the local community who might otherwise feel isolated and unsupported."

The meeting on Saturday, 25th March, is between 10.30am and 12.30pm in The Lecture Theatre (first floor), Macclesfield District General Hospital, Victoria Road, Macclesfield, Cheshire SK10 3BL.

Anaphylaxis Campaign CLO Lyne Regent said: "It's brilliant that Paul runs a support group for us in Macclesfield. Many people in the general population do not understand just how serious allergy and anaphylaxis can be."

"Our support groups, like the one Paul is running, provide a vital touch point for affected families and individuals and are a really positive way for them to support each other."

For more details visit <http://www.anaphylaxis.org.uk/product/support-group-macclesfield> or email Mr.Moses@allergycheshire.co.uk

Cooking course serves menu of culinary skills

The next basic cookery course starts next month.

Since the Cooking From Scratch project began last year, Cheshire Learning Partnership has brought back basic cookery skills to more than 140 families, creating more than 3,000 quick, healthy and budget friendly meals.

The next six-week course starts on Wednesday at Ruby's Fund Social Café, Meridian House, Roe Street, Congleton. Would-be chefs can choose either an afternoon course running from 1.30pm to 3.30pm or an evening course running from 7pm to 9pm.

At a recent participatory budget day held at Congleton Town Hall, local residents voted for Cooking From Scratch to be continued in the town, awarding £2,500 for future projects. The course is an opportunity to learn some cookery skills and find out how to eat well on a budget.

Adele Cooke, managing director of the partnership, said: "We are thrilled with the outcomes and feedback from the course and excited to be delivering new skills to more families in Congleton this spring."



John Lowe gets ready to cook his pizza.

To find out more or enrol, call Congleton Learning Centre on 01260 290682, visit facebook.com/congletonlearningcentre or email adele@clpic.co.uk

All organisers ask is commitment to the full six-week course.

(Submitted photographs)



Lila Jones, left, and Marian Gallagher prove that the course is fun.

Licensing Act 2003:
Application for a Variation to a Premises Licence

NOTICE is hereby given Ian Cooke has applied to Cheshire East Borough Council on 20th February 2017 for a variation to the Premises Licence in relation to 6 Crewe Road, Alsager ST7 2ES now known as Six Bar & Grill.

The application seeks to :

Remove condition 7 of Annex 2, extend the licensable area and to amend licensable activities to

Supply of Alcohol, Late Night Refreshment Live Music and Recorded Music

Monday to Thursday 11.00 to midnight

Friday and Saturday 11.00 to 00.30

Sunday 11.00 to 23.30

Any person wishing to make representation in relation to this application may do so in writing by 20th March 2017 to:

The Licensing Section, Cheshire East Borough Council, Municipal Buildings, Earle Street, Crewe, CW1 2BJ

The application may be inspected at the Licensing Section of Cheshire East Borough Council at the address above by prior appointment during normal office hours.

It is an offence on summary conviction, to knowingly or recklessly make a false statement in connection with this application, the maximum fine for which is, unlimited.